

LANCASTER CENTRIFUGAL - "TWO-STAGE" END SUCTION PUMPS

The Lancaster "Two-Stage" End Suction Centrifugal Pumps offer efficient pumping for dependable water transfer, circulating or booster service.

FEATURES:

- Capacities to 60 gpm
- Heads to 175 feet
- 1-1/4" N.P.T. Inlet, 1" N.P.T. Outlet
- Non-overloading impellers
- Maximum working pressure 125 PSI
- Maximum liquid temperature 140° F

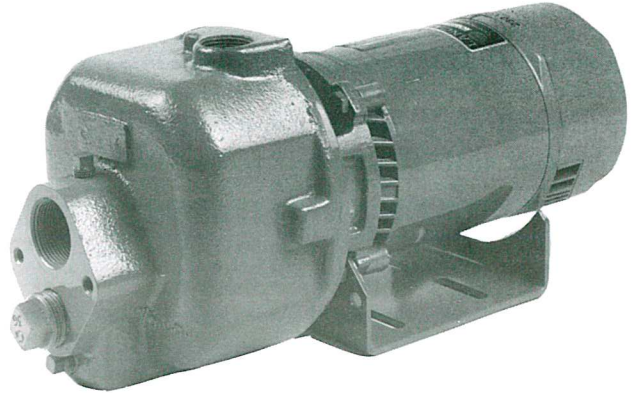

PUMP SPECIFICATIONS:

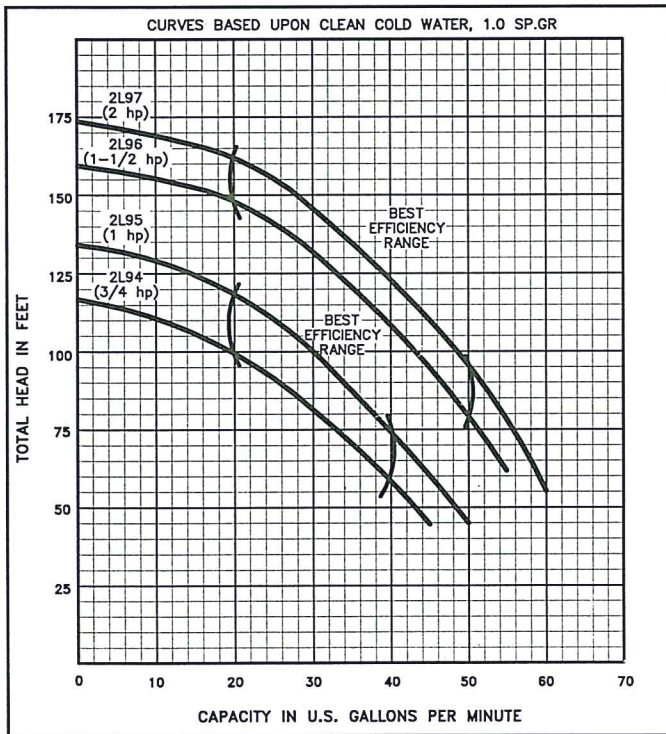

PUMP BODY AND MOTOR ADAPTER: Cast iron

PUMP BASE: Steel

SHAFT SEAL: Carbon/ceramic seats, Buna-N elastomers and stainless steel parts.

DIFFUSERS: 20% Glass Filled Delrin® (Acetal).

IMPELLERS: 20% Glass Filled Noryl® with stainless steel threaded inserts.

MOTOR SPECIFICATIONS:

3450 RPM, 60 HZ, ODP MOTORS					
MODEL	H.P.	S.F.	PHASE	VOLTAGE	FRAME
2L94	3/4	1.50	1	115/230	56J
2L95	1	1.40	1	115/230	56J
2L96	1-1/2	1.30	1	115/230	56J
2L97	2	1.20	1	115/230	56J

For TEFC and 3 PH motors - Consult Factory

LANCASTER PUMP A DIVISION OF C-B TOOL CO.

1340 Manheim Pike, Lancaster, PA 17601-3196 • Phone 717/397-3521 • Fax 717/392-0266 • www.lancpump.com