



DIAMOND LINE - LX QUICK-START GUIDE

PLEASE NOTE: For complete instructions refer to manual.

User Displays

When the system is in normal service mode, one of up to five available User Displays will be shown. Pressing **NEXT** will alternate between the following displays:

- Current time of day
- Treated water flow rate
- Service contact name and phone number (if entered)
- Remaining Capacity of treated water available
- Remaining days to regeneration (if Day Override programmed)

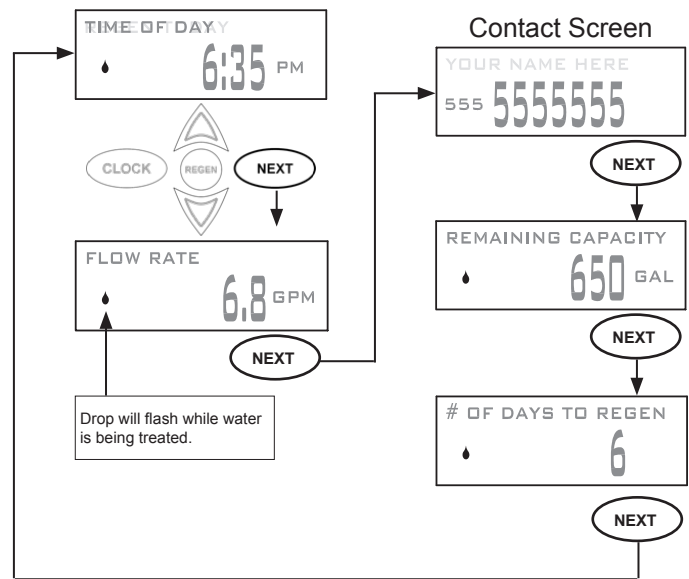

Set Time of Day

Current time of day needs to be entered during initial installation, and adjusted when daylight saving time begins or ends. If an extended power outage occurs and depletes the on-board non-rechargeable coin cell battery, when power resumes the time of day should be reset and battery replaced.

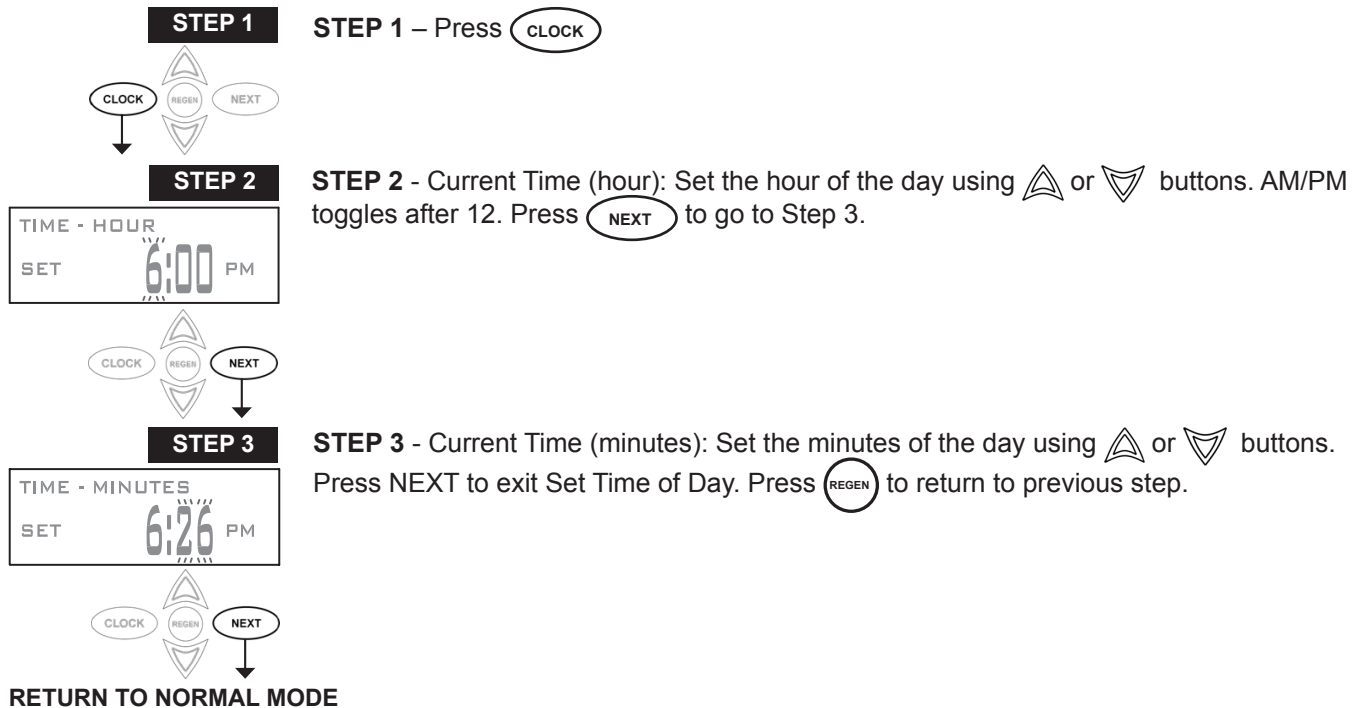

Low Battery

A non-rechargeable coin cell battery is located on the circuit board, used only to maintain the time of day during power outages (all other information will be stored in memory no matter how long the power outage). The screen displays **LOW BATTERY** when the battery needs to be replaced. The screen will remain illuminated solid blue when **LOW BATTERY** is displayed. Initially **LOW BATTERY** display will alternate with the User display, finally displaying only **LOW BATTERY**. User displays are still accessible by pressing **NEXT**.

Installer Displays

Adjust Hardness, Days Between Regenerations, or Time of Regeneration

STEP 1

STEP 1 - Press **NEXT** and **▲** simultaneously for 3 seconds.



STEP 2

STEP 2 – Hardness: Set the amount of hardness in grains of hardness as calcium carbonate per gallon using the **▲** or **▼** buttons. The default is 20 with value ranges from 1 to 150 in 1 grain increments. Note: The grains per gallon can be increased if soluble iron needs to be reduced. Press **NEXT** to go to step 3. Press **REGEN** to exit Installer Display Settings.



STEP 3

STEP 3 – Day Override: Set the maximum number of days between regenerations. If value is set to “OFF”, regeneration initiation is based solely on volume used. If value is set as a number (allowable range from 1 to 28) a regeneration initiation will be called for on that day even if sufficient volume of water were not used to call for a regeneration. Set Day Override using **▲** or **▼** buttons:

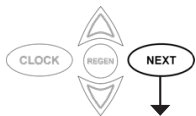

- number of days between regeneration (1 to 28); or
- “OFF”.

Press **NEXT** to go to step 4. Press **REGEN** to return to previous step.

STEP 4

STEP 4 – Next Regeneration Time (hour): Set the hour of day for regeneration using **▲** or **▼** buttons. AM/PM toggles after 12. The default time is 2:00 AM. Press **NEXT** to go to Step 5. Press **REGEN** to return to previous step.

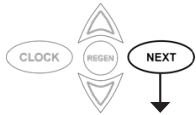

STEP 5

STEP 5 – Next Regeneration Time (minutes): Set the minutes of day for regeneration using **▲** or **▼** buttons. Press **NEXT** to return to normal operation. Press **REGEN** to return to previous step.

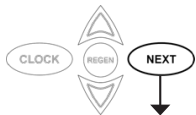

RETURN TO NORMAL MODE

To **shut-off water** to the system, please position arrow handles as shown in the **bypass operation** diagram below. If your valve doesn't look like the diagram below, contact your service technician for instructions on how to shut-off water.

NORMAL OPERATION

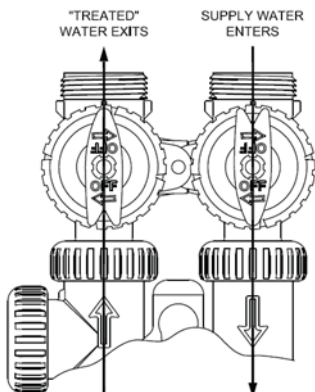

BYPASS OPERATION

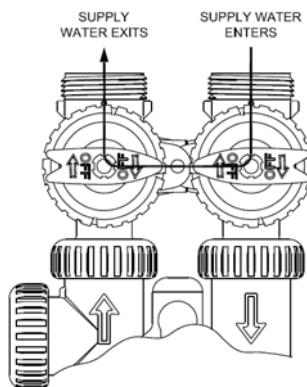

NOTES:

| | |
|-------------------------|-----------------------|
| Model number: | Water Pressure: _____ |
| Installation date: | Hardness (gpg): _____ |
| Installer name: | Iron (ppm): _____ |
| Installer phone number: | pH: _____ |
| | Other: _____ |



A DIVISION OF C-B TOOL CO.